

Technical Specifications

Acoustic cabinet:	FR206
Description:	2 Way Compact System. 6,5" Woofer and Coaxial unit
Power AES:	400 W.
Power Program:	800 W.
Sensitivity 2,83v @ 1m:	93 dB.
Max. SPL continuous:	119 dB.
Max. SPL peak:	125 dB.
Frequency response:	60 - 20.000Hz.
Coverage (H x V):	70° Conical
Bass Loudspeakers:	6P200Nd or 6P200Fe
Coaxial unit:	6CX200Nd
Crossover:	FP-206
Hardware:	External

Lateral vista sección

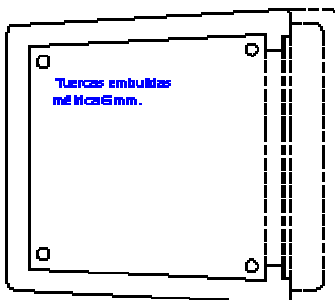

Vista frontal

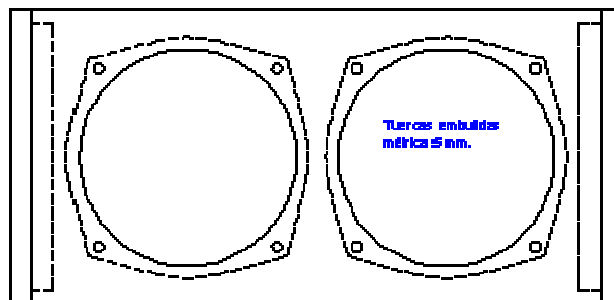

Lateral vista sección

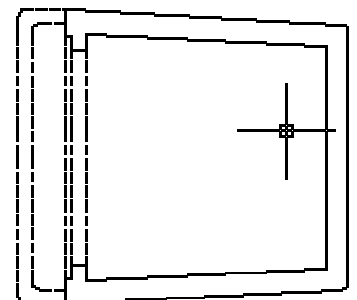

Lateral vista desde fuera

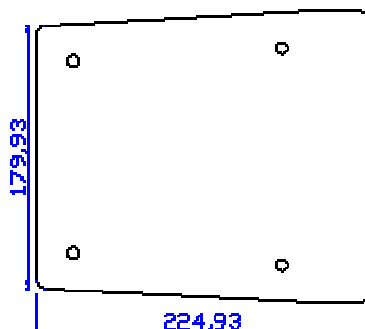

Vista trasera

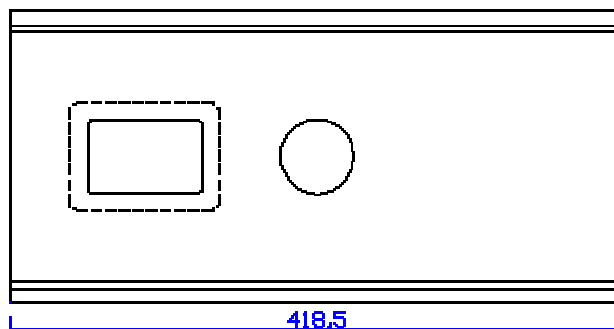

Lateral vista desde fuera

